

# WEST RIVER VALLEY SENIOR HOUSING

SITE DESIGN *Townshend, Vermont*

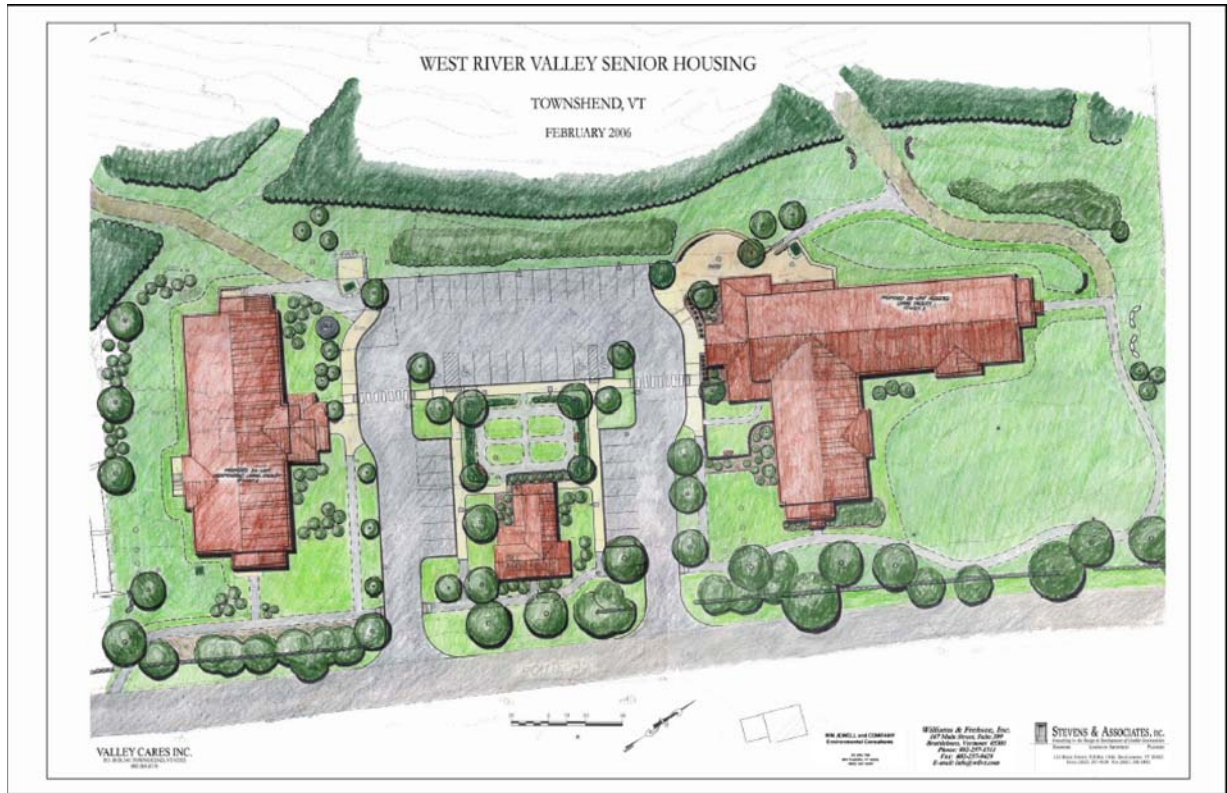

Stevens and Associates provided site design, civil engineering and environmental permitting for this 50,000 square foot, \$10,000,000 senior housing facility. The project consisted of a 28 unit assisted living facility and a 24 unit independent living facility. Site construction included parking lots, handicapped accessible sidewalks, sidewalks, gardens and pathways. The project also required complex stormwater systems and on site community water system and septic treatment.

Financing was provided in part by the federal Department of Housing and Urban Development, Vermont Housing Finance Agency, local banks and private fundraising.



**STEVENS & ASSOCIATES, P.C.**  
*Consulting in the Design & Development of Livable Communities*

ENGINEERS LANDSCAPE ARCHITECTS PLANNERS

**Client's Project Manager:** Bob Crego  
**Phone Number:** (802) 365-4115  
**Address:** PO Box 341  
Townshend, VT 05353